

# CORNER RECORD

Document Number CR 1030

City of San Leandro County of Alameda, California

Brief Legal Description LOT 9, Map of the Subdivision of BLOCK NO. 6, BROADMOOR  
filed October 3, 1914, Book 28 Maps, Page 77

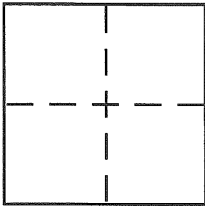

## CORNER TYPE

Government Corner ☐ Control ☐  
 Meander ☐ Property ☒  
 Rancho ☐ Other ☐  
 Date of Survey Oct. 18, 2001

## COORDINATES (Optional)

N. \_\_\_\_\_  
 E. \_\_\_\_\_  
 Zone \_\_\_\_\_ NAD27 ☐ NAD83 ☐  
 NAD83 Epoch \_\_\_\_\_  
 Elev. \_\_\_\_\_  
 Vert. Datum: NGVD29 ☐ NAVD88 ☐  
 Meas. Units: Metric ☐ Imperial ☒

Corner - Left as found ☐ Found and tagged ☐ Established ☒ Reestablished ☐ Rebuilt ☐

Identification and type of corner found: Evidence used to identify or procedure used to establish or reestablish the corner:  
Due to lack of monumentation, street R/W lines were established by  
splitting existing curb construction as indicated on Page 2.  
Held record relationship of lines surveyed with N/Wly R/W of  
Dutton Ave. and S/Wly R/W of Beverly Ave. as shown on the  
Map of the Subdivision of Block No. 6, Broadmoor. (See Pg. 2.)

A description of the physical condition of the monument as found and as set or reset: See Legend  
(Page 2.)

## SURVEYOR'S STATEMENT

This Corner Record was prepared by me or under my direction in conformance with  
 the Land Surveyor's Act on October 19, 2001

Signed Gordon Lee Glenn P.L.S. or R.C.E. No. 5666

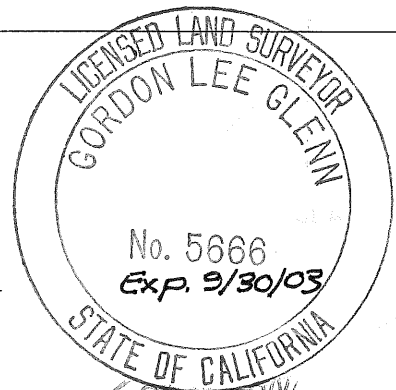

## COUNTY SURVEYOR'S STATEMENT

This Corner Record was received 1.03.02

and examined and filed 12.20.02

Signed Russell R. Penland, Jr. P.L.S. or R.C.E. No. 5726

Title COUNTY SURVEYOR

County Surveyor's Comment \_\_\_\_\_

