

FAN #3 FARDCR7 - EXHAUST FAN

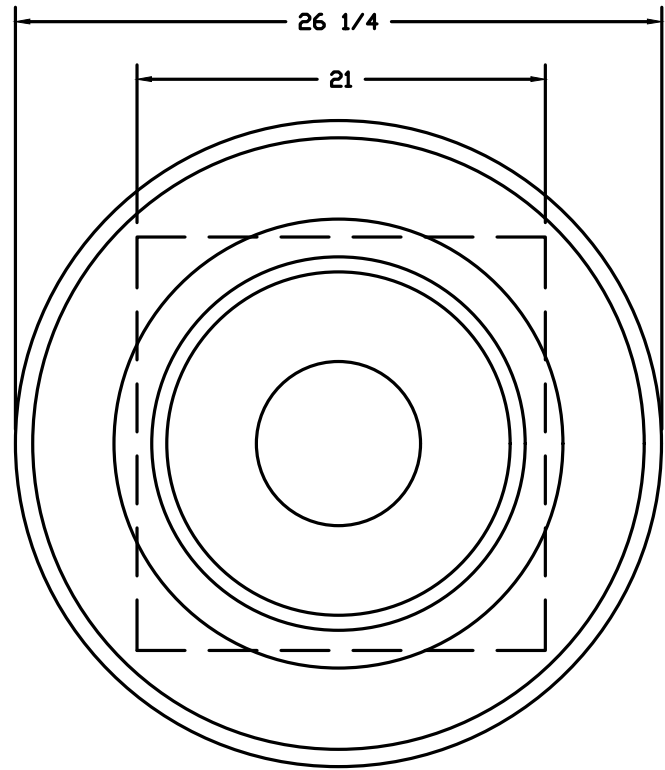

TOP VIEW

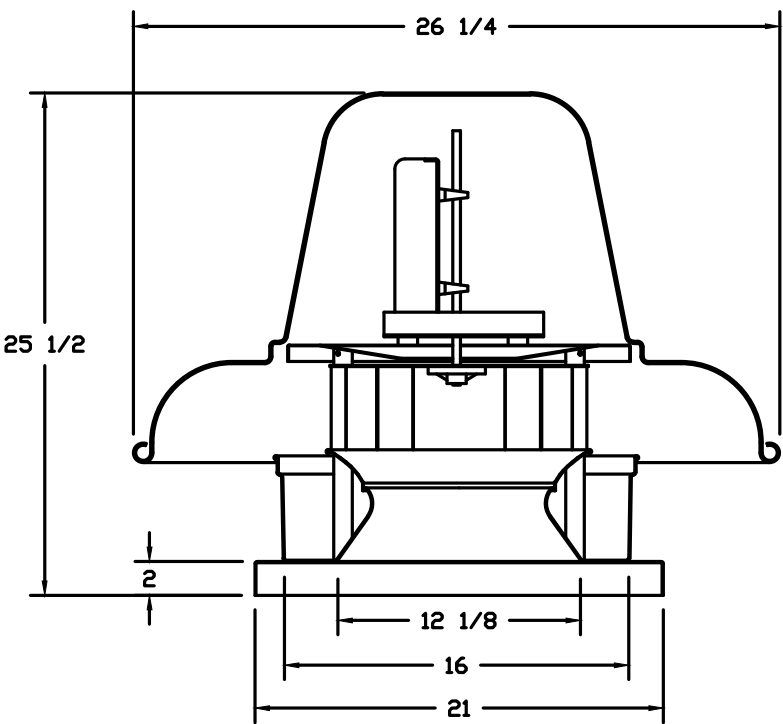

FEATURES:

- ROOF MOUNTED FANS.
- UL705.
- AMCA SOUND AND AIR CERTIFIED.
- WIRING FROM MOTOR TO DISCONNECT SWITCH.
- DISCONNECT SWITCH.
- STANDARD BIRD SCREEN.

OPTIONS

- 1 15-BDD DAMPER.
- 2 YEAR PARTS WARRANTY.

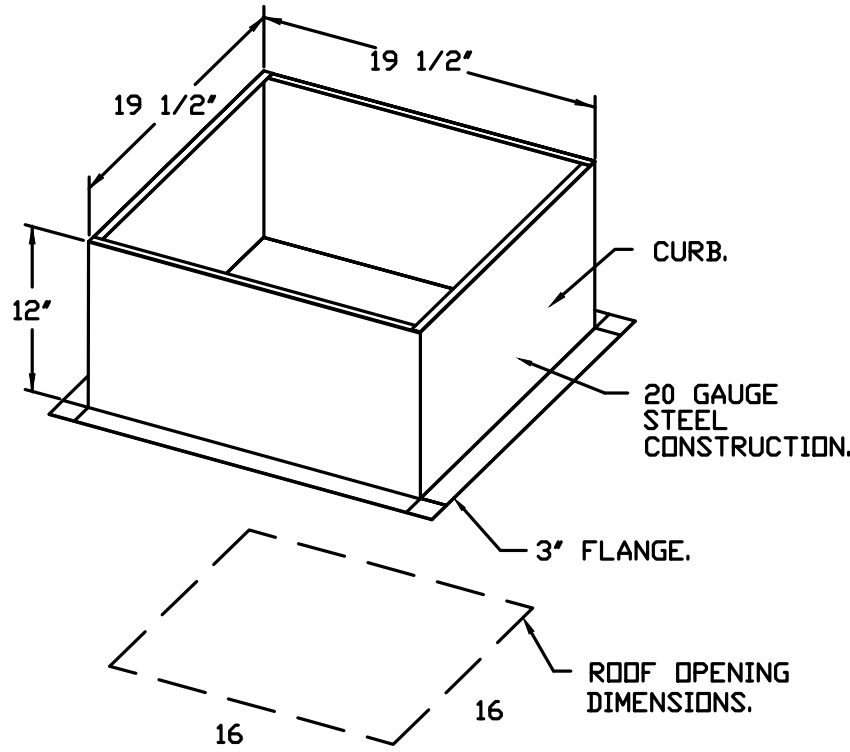

PITCHED CURBS ARE AVAILABLE FOR PITCHED ROOFS.

SPECIFY PITCH:  
EXAMPLE: 7/12 PITCH = 30° SLOPE.

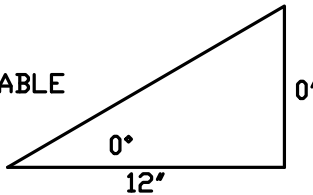

BACKDRAFT DAMPER INSTALLATION

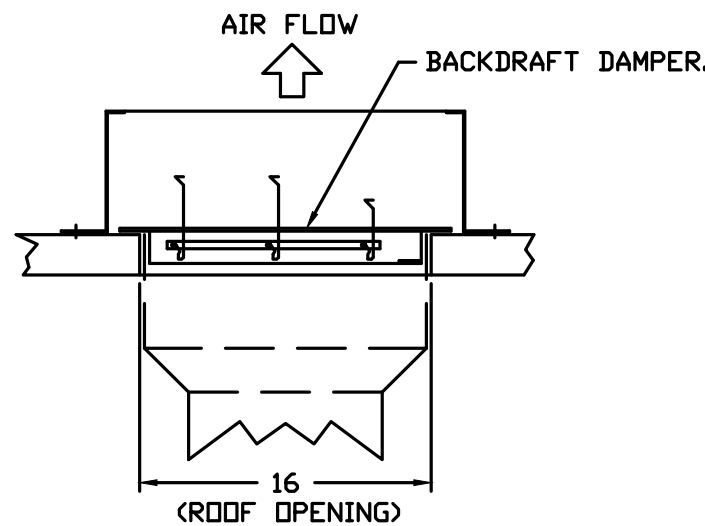

REVISIONS	
DESCRIPTION	DATE
Δ	
Δ	
Δ	
Δ	

**CAPTIVE**



**Southern California Office**  
3002 Dow Ave., Suite #10, Tustin, CA 92780 PHONE: (714) 957-1500 FAX: (919) 227-5975 EMAIL: rag86@captliveaire.com

Panda Express - Tampa FL (D8135)

, 0

DATE: 2/18/2021

DWG.#:  
4748429

DRAWN BY: AH-86

SCALE:  
3/4" = 1'-0"

MASTER DRAWING

SHEET NO.  
5



PANDA RESTAURANT GROUP INC.  
1683 Walnut Grove Ave.  
Rosemead, California  
91770  
Telephone: 626.799.9898  
Facsimile: 626.372.8288

All ideas, designs, arrangement and plans indicated or represented by this drawing are the property of Panda Express Inc. and were created for use on this specific project. None of these ideas, designs, arrangements or plans may be used by or disclosed to any person, firm, or corporation without the written permission of Panda Express Inc.

REVISIONS:

ISSUE DATE:

1	04.29.2021 ISSUE FOR PERMIT
2	06.04.2021 ISSUE FOR BID

DRAWN BY: SDT

PANDA PROJECT #: - S8-22-D8135  
C&P PROJECT #: - 2200775



2600 Maitland Center Pkwy, Maitland, FL 32751  
P (407) 661-9100  
F (407) 661-9101  
www.c&p.com  
Florida Engineer's Certificate #AA 139026

06.04.2021

PANDA EXPRESS

TRUE WARM AND WELCOME 2300  
SKYBROOKE BOULEVARD & STATE ROAD 54  
LUTZ, FL 33558

M-404

HOOD DETAIL PLAN

TRUE WARM & WELCOME 2300 R4