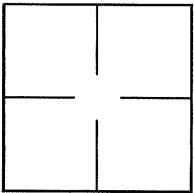

# CORNER RECORD

Agency Index **BK 100 PG 90**Document Number **CR 10451**City of OAKLANDCounty of ALAMEDA, CaliforniaBrief Legal Description INTERNATIONAL BLVD. AND 83RD AVE.

## CORNER TYPE

Government Corner ☐ Control  
Meander ☐ Property  
Rancho ☐ Other

## COORDINATES (Optional)

N. \_\_\_\_\_ E. \_\_\_\_\_

☒ Elevation \_\_\_\_\_Units Metric ☐ U.S. Survey Foot ☒☐ Horizontal Datum \_\_\_\_\_

Zone \_\_\_\_\_ Epoch Date \_\_\_\_\_

Vertical Datum \_\_\_\_\_

Date of Survey MAY 19, 2017☐ Complies with Public Resources Code §§8801-8819☐ Complies with Public Resources Code §§8890-8902PLS Act Ref: ☐ 8765(d) ☒ 8771 ☐ 8773 ☐ Other:

Corner/  
Monument: ☒ Left as found ☐ Established ☐ Rebuilt ☒ Pre-Construction  
☐ Found and tagged ☐ Reestablished ☐ Referenced ☐ Post-Construction

Narrative of corner identified and monument as found, set, reset, replaced, or removed:

☒ See sheet #2 for description(s):

FOUND 2-1/2" BRASS DISK WITH NO PUNCH STAMPED 'CALIFORNIA DEPT OF TRANSPORTATION', LOCATED IN MONUMENT WELL AT THE INTERSECTION OF INTERNATIONAL BOULEVARD AND 83RD AVENUE.

SET NAIL AND TAG, STAMPED LS 8593 AS REFERENCE POINTS TO BE USED TO RESET MONUMENT SHOULD IT BE DISTURBED DURING CONSTRUCTION ACTIVITIES.  
SEE SHEET 2 FOR GRAPHIC

## SURVEYOR'S STATEMENT

This Corner Record was prepared by me or under my direction in conformance with the Professional Land Surveyors' Act on JULY 7, 2017

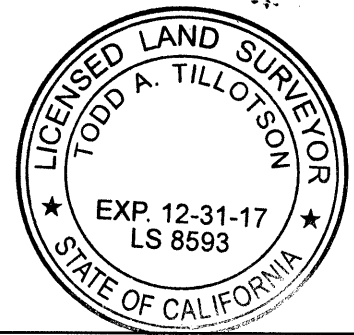
Signed [Signature] P.L.S. or R.C.E. No. 8593

## COUNTY SURVEYOR'S STATEMENT

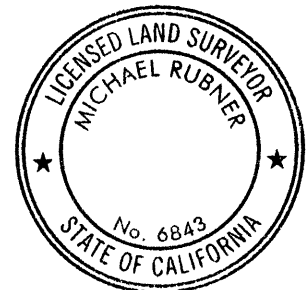
This Corner Record was received 26 JULY, 2017and examined and filed 1 SEPTEMBER, 2017Signed Michael Rubner P.L.S. or R.C.E. No. 6843Title COUNTY SURVEYOR

County Surveyor's Comment \_\_\_\_\_

