

# CORNER RECORD

Agency Index

BK 118 PG 29

Document Number

CR 12369

City of EDEN TOWNSHIP

County of ALAMEDA, California

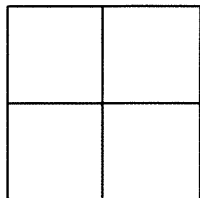
Brief Legal Description MONUMENT LOCATED WITHIN N. 5TH ST  
NEXT TO 1969 LEILA ST

## CORNER TYPE

Government Corner	<input type="checkbox"/>	Control	<input checked="" type="checkbox"/>
Meander	<input type="checkbox"/>	Property	<input type="checkbox"/>
Rancho	<input type="checkbox"/>	Other	<input type="checkbox"/>

Date of Survey 9/14/18

## COORDINATES (Optional)

N. 2075226 E. 6105395

Elevation

Units Metric ☐ U.S. Survey Foot ☐

Horizontal Datum

Zone Epoch Date

Vertical Datum

☐ Complies with Public Resources Code §§8801-8819☐ Complies with Public Resources Code §§8890-8902PLS Act Ref: ☐ 8765(d)☒ 8771☐ 8773☐ Other:Corner/Monument: ☒ Left as found☐ Established☐ Rebuilt☐ Pre-Construction☐ Found and tagged☐ Reestablished☐ Referenced☒ Post-Construction

Narrative of corner identified and monument as found, set, reset, replaced, or removed:

☐ See sheet #2 for description(s) : SEE 93 CR 14 SEE CR 11593

FOUND SEVERELY DEGRADED IRON PIPE WITH NAIL IN MONUMENT WELL

FOUND AND SET POINTS AS SHOWN ON PAGE 2.

THIS POINT WAS FOUND IN SAME CONDITION AFTER A CONSTRUCTION PROJECT IN THE VICINITY.  
THE TIES SHOWN HEREON ARE FOR THE PURPOSE OF PERPETUATING FOUND MONUMENTATION.  
NO CLAIM IS MADE AS TO THE RELATIONSHIP OF THE POINTS OR LINES SHOWN HEREON TO TRUE  
BOUNDARY LOCATION.

## SURVEYOR'S STATEMENT

This Corner Record was prepared by me or under my direction in conformance with

the Professional Land Surveyors' Act on SEPTEMBER 18, 2018.

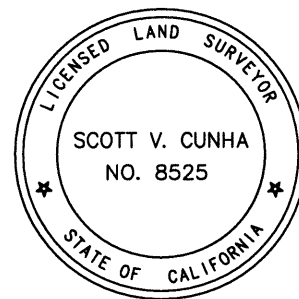
Signed Scott V. Cunha P.L.S. or R.C.E. No. LS 8525  
SCOTT V. CUNHA

## COUNTY SURVEYOR'S STATEMENT

This Corner Record was received 12 OCTOBER 2018

and examined and filed 1 FEBRUARY 2019

Signed Michael Rubner P.L.S. or R.C.E. No. 6843

Title COUNTY SURVEYOR

County Surveyor's Comment



SPEC-2355-Post

SCALE: 1"=30'

## LEGEND

- FOUND IRON PIPE WITH NAIL IN MONUMENT WELL
- ⊗ FOUND CUT CROSS IN WALK
- ✕ FOUND CUT CROSS IN CURB
- FOUND REBAR & CAP STAMPED "CEI RP"
- FOUND REBAR & CAP
- AA##A# ALAMEDA COUNTY MONUMENT ID
- 19592 REFERENCE STREET ADDRESS

LEILA ST

1969

TA61H4

N. 5TH ST

22245

218078-Grove-POST-CR-5