

BK 38 Pg 37

CORNER RECORD

Document Number CR 4314 CR 4314

City of OAKLAND County of ALAMEDA California

Brief Legal Description BRASS DISC MONUMENT LOCATED WITHIN THE INTERSECTION OF CLAREMONT CLAREMONT AVENUE AND HUDSON STREET. (36/F-R)

5

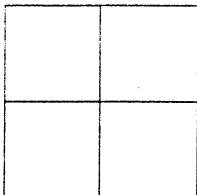

CORNER RECORD

COORDINATES (Optional)

Government Corner ☐ Control ☒
Meander ☐ Property ☐
Rancho ☐ Other ☐
Date of Survey 9/7/10

N. _____
E. _____
Zone _____ Datum _____
Elev. _____

Corner — Left as found ☒ Found and tagged ☐ Established ☐ Reestablished ☐ Rebuilt ☐

Identification and type of corner found: Evidence used to identify or procedure used to establish or reestablish the corner:
FOUND BRASS DISC MONUMENT LOCATED WITHIN THE INTERSECTION OF CLAREMONT AVENUE AND HUDSON STREET. AS SHOWN ON CITY OF OAKLAND MONUMENT MAP, PAGE 310.

THIS POINT WAS REFERENCED PRIOR TO A CONSTRUCTION PROJECT IN THE VICINITY.

A description of the physical condition of the monument as found and as set or reset:
FOUND AND SET POINTS AS SHOWN ON PAGE 2.

SURVEYOR'S STATEMENT

This Corner Record was prepared by me or under my direction in conformance with the Land Surveyors' Act on SEPTEMBER 8, 2010.

Signed Vincent H. Cunha L.S. Number LS 4520
VINCENT H. CUNHA



COUNTY SURVEYOR'S STATEMENT

This Corner Record was received 10-4-2010 and examined

and filed 11-16-2010.

Signed Russell R. Penland Title County Surveyor

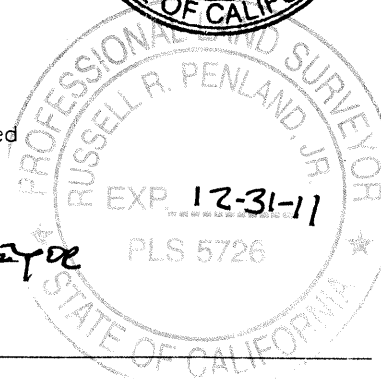

County Surveyor's Comment

MARTIN
STREET

CALIFORNIA STATE HIGHWAY MONUMENT MAP
S-164.14

LEGEND

● FOUND BRASS DISC IN MONUMENT WELL($\frac{36/F-R}{5}$)

◎ FOUND MONUMENT AS NOTED

✕ FOUND CUT CROSS IN CONCRETE

✕ SET NAIL AND TAG LS 4520

UR12Q3 ALAMEDA COUNTY MONUMENT ID

(SEE CR 4315)

UR12Q3

HUDSON
STREET

GROVE-SHAFTER FREEWAY