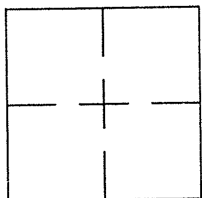

CORNER RECORD

Document Number CR 6465City of OAKLANDCounty of ALAMEDA, CaliforniaBrief Legal Description WELL MONUMENT LOCATED WITHIN ORCHID ST AND 34TH AVE.

CORNER RECORD

Government Corner ☐Meander ☐Rancho ☐Date of Survey 08/13/2014Control ☒Property ☐Other ☐COORDINATES
(Optional)

N. _____

E. _____

Zone _____ Datum _____

Elev. _____

Corner —

Left as found ☒ Found and tagged ☐ Established ☐ Reestablished ☐ Rebuilt ☐Identification and type of corner found: Evidence used to identify or procedure used to establish of reestablish the corner:
FOUND BRASS DISC IN WELL MONUMENT IN INTERSECTION OF ORCHID ST AND 34TH AVE.AS SHOWN ON CITY OF OAKLAND MONUMENT MAP, PAGE 153NO CITY MONUMENT DESIGNATION NUMBER AT SUBJECT LOCATION.THIS POINT WAS REFERENCED PRIOR TO A CONSTRUCTION PROJECT IN THE VICINITY.

A description of the physical condition of the monument as found and as set or reset: _____

FOUND AND SET POINTS AS SHOWN ON PAGE 2.THESE TIES ARE FOR THE PURPOSE OF PERPETUATING THE FOUND MONUMENTATION.NO CLAIM IS MADE AS TO THE RELATIONSHIP OF THE POINTS OR LINES SHOWN HEREON
TO TRUE BOUNDARY LOCATIONS.

SURVEYOR'S STATEMENT

This Corner Record was prepared by me or under my direction in conformance with
the Land Surveyors' Act on AUGUST 22, 2014.Signed Vincent H. Cunha L.S. Number L5 4520

VINCENT H. CUNHA

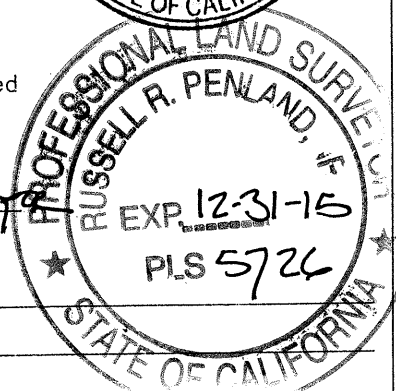

COUNTY SURVEYOR'S STATEMENT

This Corner Record was received 8-28-2014 and examinedand filed 10-6-2014.Signed Russell R. PenlandTitle County Surveyor

County Surveyor's Comment _____

AF4897



SCALE: 1"=30'

LEGEND

- FOUND IRON PIN IN MONUMENT WELL
- ✕ SET CUT CROSS IN CONCRETE
- NO EXISTING MONUMENT ID

