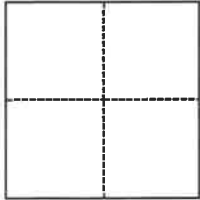

# CORNER RECORD

Agency Index BK 140 PG 64Document Number CR 15385City of Oakland (APN 29-1070-42-2) County of Alameda, CaliforniaBrief Legal Description Monument in Wisconsin Street, near 3362 Wisconsin Street**CORNER TYPE**

- ☐ Government Corner ☒ Control  
☐ Meander ☐ Property  
☐ Rancho ☐ Other

Date of Survey May 25, 2021**COORDINATES (Optional)**N.                      E.                     Elevation                     Units ☐ Metric ☒ U.S. Survey FootHorizontal Datum                     Zone                      Epoch Date                     Vertical Datum                     ☐ Complies with Public Resources Code §§8801-8819☐ Complies with Public Resources Code §§8890-8902PLS Act Ref.: ☐ 8765(d) ☒ 8771 ☐ 8773 ☐ Other:Corner/ ☒ Left as found ☐ Established ☐ Rebuilt ☒ Pre-ConstructionMonument: ☐ Found and tagged ☐ Reestablished ☒ Referenced ☐ Post-Construction

Narrative of corner identified and monument as found, set, reset, replaced, or removed:

☒ See sheet #2 for description(s):

Found monument that could be damaged or destroyed by planned water line construction project. Monument was referenced as shown on page 2. The purpose of this Corner Record is to preserve possible evidence only; no attempt was made to determine the relationship to property, centerline, or right of way lines.

Reference EBMUD CR Book C, Page 9 (Kong/Chou)

**SURVEYOR'S STATEMENT**

This Corner Record was prepared by me or under my direction in conformance with

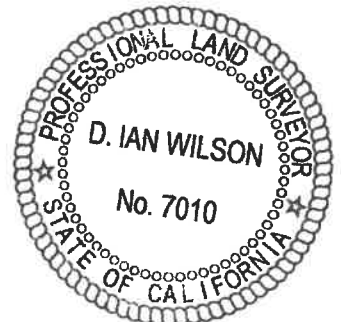
the Professional Land Surveyors' Act on August 24, 2021Signed  P.L.S. or R.C.E. No. 8889**COUNTY SURVEYOR'S STATEMENT**This Corner Record was received                     and examined and filed SEP 02 2021Signed  P.L.S. or R.C.E. No. 7010Title ALAMEDA COUNTY SURVEYOR**County Surveyor's Comment**

OAKLAND

ALAMEDA COUNTY

PLAT OF  
THE PART OF THE  
RANCHO SAN ANTONIO  
FINALLY CONFIRMED  
TO ANTONIO MARIA  
PERALTA, ETAL.  
A M 669

NORTON  
AVENUE

WISCONSIN

3362 WISCONSIN STREET  
APN 29-1070-42-2TRACT 629  
11 M 40  
11

12

STREET

[100.14']  
10.2' NW'LY OF  
E WOOD GATE[101.10']  
2' SE'LY OF  
STOP SIGN

48.68'

18.30'

[100.00']

19.76'

[100.32']  
2.7' W'LY  
OF JP

29.15'

[99.39']  
8.5' N'LY OF  
P/L OF 3361  
& 3365LEGEND

FOUND 1/4" PIN IN CONCRETE IN STANDARD MONUMENT WELL, 0.8' BELOW GRADE

SET CONCRETE ANCHOR NAIL AND 1-1/2" ALUMINUM WASHER, STAMPED "EBMUD MON RP"  
IN TOP OF CURB

ASSUMED ELEVATION (MEASURED USING A LEICA DIGITAL LEVEL)

SCALE  
1"=20'

ADDRESS: 3362 WISCONSIN STREET APN: 29-1070-42-2